

Features

YQM3030F Series

- Low-loss SAW filter
- Low amplitude ripple
- No matching network required for operation at 50Ω
- SMD package for Surface Mounted Technology (SMT)
- Lead-free production and RoHS Compliant Electrostatic
- Sensitive Device(ESD)
- Moisture Sensitivity Level 1

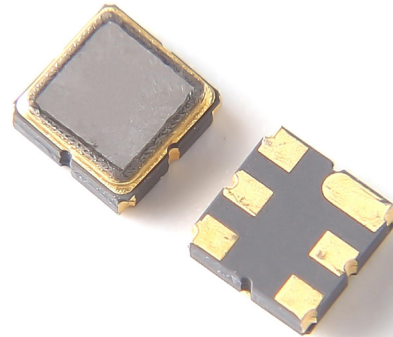

SMD Type

Low Insetion Loss

Standard Specifications

Part Family	Center Frequency (MHz)	Bandwith (MHz)	Insertion Loss (dB) max.	Package Code
YQM3030F	224~3550	As low as 0.3	As low as 0.6	SMD3030
For other parameters, please consult.				

Dimensions [Unit: mm]

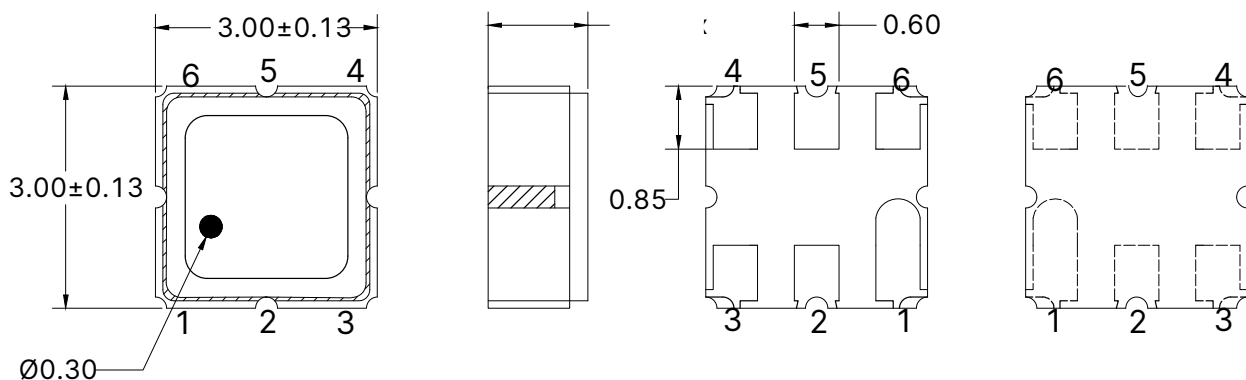

Pin Configuration	
2	Input
5	Output
1, 3, 4, 6	To Be Ground